

# TOSHIBA

**e-STUDIO6526AC**

**e-STUDIO6527AC**

**e-STUDIO7527AC**

## Colour Multifunctional Printers

- High-end multifunctional A3 colour systems for enhanced levels of productivity with an outstanding high-volume document output at a speed of up to 75 pages per minute
- Large and fully customisable touch-screen user interface for ease of use, improved efficiency and automated workflows
- Easy integration into modern business environments, including cloud and mobile printing functionality



## Future-proof your business with cloud-ready and secure technology

Today's new hybrid work environment has permanently changed demands for access to information: it must be available anywhere and anytime. Only then can organisations maintain maximum efficiency and productivity, yet information also needs to be secure.

Toshiba's cloud-ready products and our team of experts provide the solutions you need to improve workflow and print with functionalities that are smarter and more convenient than ever before. We have implemented new features to increase productivity with the vision of Together Information – helping people and organisations share information more effectively through better products and solutions. In line with the needs of the flexible work model, the series is equipped with functionalities that enable remote and hybrid working.

Based on the latest technological advances and security standards, we deliver end-to-end tailored solutions to help you seamlessly and securely navigate today's digital workplace. In addition, our multifunctional print (MFP) systems meet the highest environmental requirements. From consulting, cloud migration and fleet management to implementation and technical support, Toshiba is at your side.

Our colour MFPs allow you to show your true colours: sharp, vibrant images in all hues can make your documents more beautiful and engaging. Toshiba's e-STUDIOI07527Ac series delivers image quality that stands out. In addition, the multifunctional systems are equipped with advanced features that meet the most exacting needs of today's and tomorrow's workplaces.

- Advanced Toshiba e-BRIDGE Next controller technology for easy customisation of document workflows and integration into IT environments
- High-quality output with a resolution of up to 1,200 x 1,200 dpi
- Colour consistency across small and large print jobs

As a leading provider of information technology, Toshiba has always placed top priority on protecting data. The e-STUDIOI07527Ac series comes with advanced security features, such as anti-malware function, secure Solid State Drive (SSD) and Trusted Platform Module (TPM) with encryption function. Optionally you can choose the FIPS HDD\* with data overwrite function and HCD-PP\*\* certification. The systems are fully compliant with the EU General Data Protection Regulation (GDPR). Deploy all the security technologies offered to ensure your data is protected when using the MFP.

## Smart, smooth and convenient design

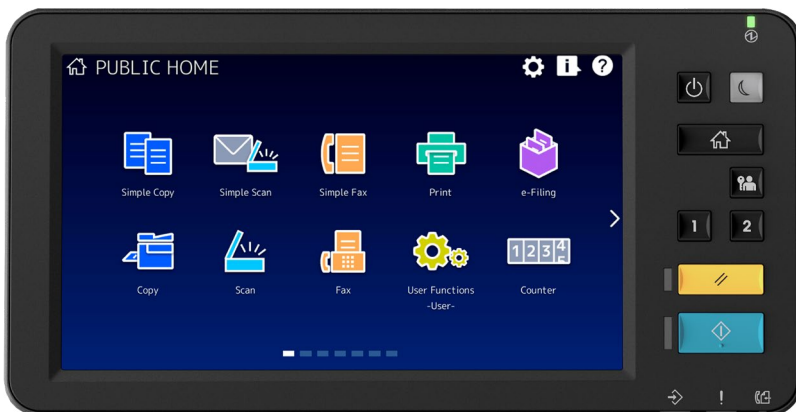

For an enhanced user experience, the devices are equipped with a large touch-screen user interface of 26 cm (10.1"), with an embedded web browser, offering a similar experience to that of using a tablet. It is easy to use and fully customisable, allowing you to conveniently tailor settings, automate workflows and integrate third-party solutions. In line with the bold look and feel of the e-STUDIO series, the user interface enables simple operation and improved efficiency.

\* Federal Information Processing Standards Hard Disc Drive  
 \*\* Hard Copy Device – Protection Profile certification

# Flexible working practices for an efficient workplace

Ideal for workgroups within medium-sized to large organisations, the e-STUDIO7527AC series is easily integrated into existing IT infrastructures. The systems are fully customisable and offer readily accessible solutions thanks to open platform architecture.

Designed for modern businesses, all systems are capable of cloud and mobile printing. AirPrint and Mopria Print Service support and address the printing needs of mobile device users, while Wi-Fi direct simplifies access to the MFP. Toshiba's exclusive e-BRIDGE Print & Capture application enables additional printing features, and gives users the ability to scan documents back to their tablets or smartphones.

The e-STUDIO7527AC series can be equipped with apps to further enhance efficiency. When the apps are combined with our embedded optical character recognition (OCR) feature, documents can be scanned as editable documents in popular office formats.

## Cloud solution apps

- e-BRIDGE Plus for Box
- e-BRIDGE Plus for Dropbox™
- e-BRIDGE Plus for Google Drive™
- e-BRIDGE Plus for Google Workspace™ Google Drive™
- e-BRIDGE Plus for Gmail™
- e-BRIDGE Plus for OneDrive®
- e-BRIDGE Plus for OneDrive® for Business
- e-BRIDGE Plus for SharePoint® Online
- e-BRIDGE Plus for Exchange Online
- e-BRIDGE Plus for Universal Print

## Workflow solution apps

- e-BRIDGE Plus for Barcode Scan
- e-BRIDGE Plus for USB Storage
- e-BRIDGE Plus for Green Information
- e-BRIDGE Plus for Zone OCR
- e-BRIDGE Plus for ID Card
- e-BRIDGE Plus for Voice Guidance

## Your partner in sustainability

Sustainability is a major topic for Toshiba and our customers. We make every effort to minimise the impact of our business on the environment, to conserve and protect the world's natural resources. This applies to every business process and product, including providing solutions that make our customers' operations more sustainable. Accordingly, the e-STUDIO7527AC series MFPs have been equipped with various environmentally friendly features:

- Low-power, super sleep mode to save money and reduce energy consumption
- Compliance with the latest, most stringent environmental requirements
- Usage of recycled plastics
- The e-BRIDGE Plus for Green Information app, which displays environmental achievements directly on the MFP to encourage use of eco-friendly settings



## Big performance in any work environment

Toshiba's e-STUDIO7527Ac series offers a wide spectrum of functionalities in a surprisingly compact format. The multifunctional units enable you to integrate and simplify your workflows while improving productivity and efficiency.

**Robust High Speeds** include 65/65/75 brilliant colour pages per minute (ppm) and 65/75/85 monochrome ppm, respectively.

**Image recovery menu** helps within minutes by providing easy guidance (including a movie) for users.

**Toner Change On-The-Fly** allows you to replace toner cartridges while the MFP is printing.

**Multi Station Print Solution** allows you to send print jobs from your desktop and retrieve them at up to 50 different MFPs by authenticating at a device, e.g. by simply swiping your ID badge.

**Interrupt print** is one of the convenient functions to make your job more efficient. Jump the queue for first priority prints.

**Embedded optical character recognition (OCR)** simplifies the creation of searchable PDFs and editable document formats such as Microsoft Word.

**Scan to USB** is great for working with documents on the go. You can even create PDF/A-2 files suitable for long-term archiving.

**Scan and fax preview** allows you to review, rotate and modify your scanned documents or incoming faxes before saving or printing them.

**Barcode printing** lets you send print data from your ERP system directly to the MFP. The barcode sequence is automatically processed and printed with no need for additional middleware.

**Print from USB** for quick and easy printouts. If required, the MFP will automatically scale your documents to fit the available paper size.

**E-mail direct printing** can automatically print attached documents from e-mails sent to the MFP.

**Remote assistance** fits seamlessly into today's workstyles and helps keep your business running when technical difficulties or uncertainties occur.



# Configuration

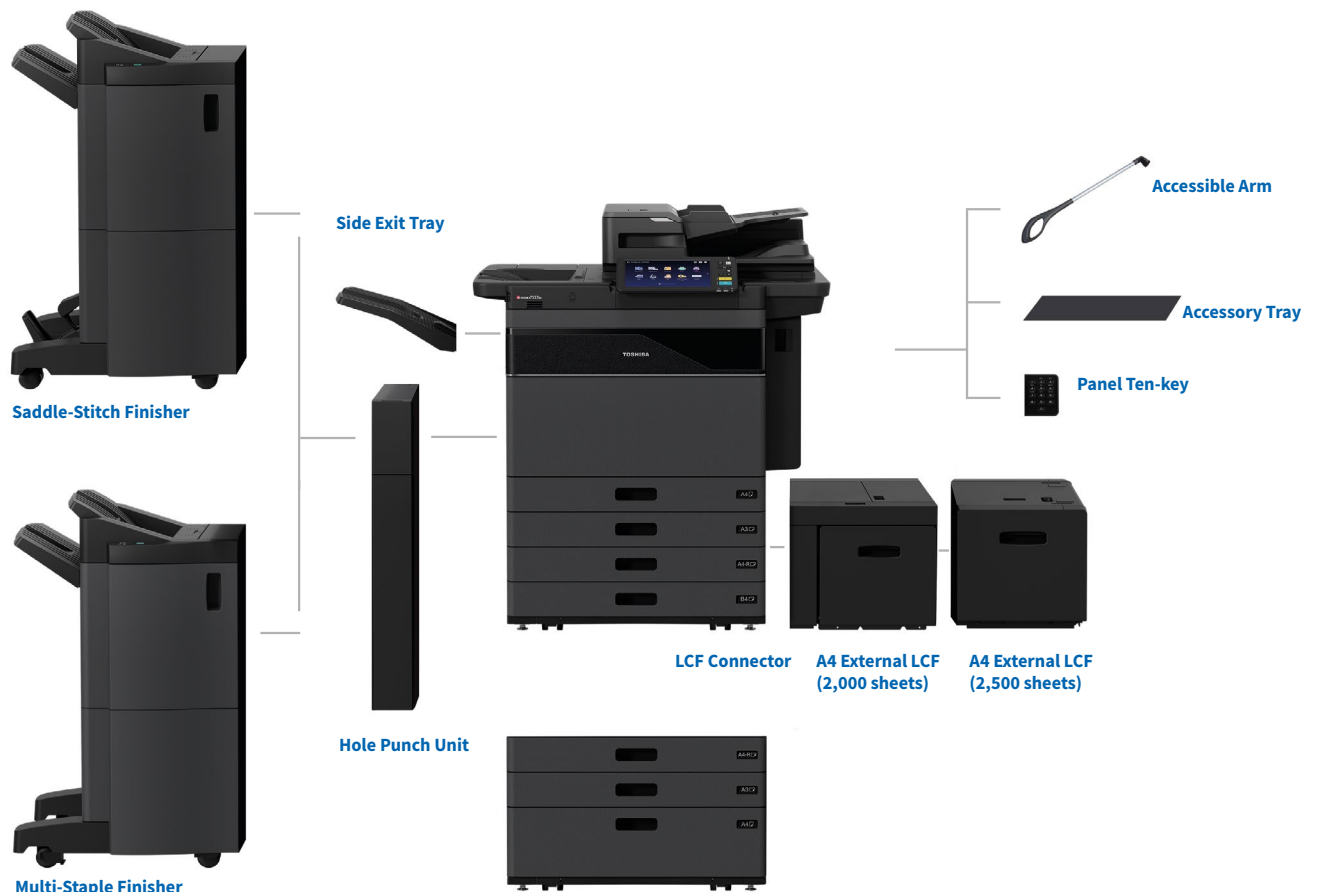

**Note:**  
The e-STUDIO6526AC is also available with two 540-sheet cassettes and one 2,320-sheet Tandem LCF.

## Highlights

### Mobile printing

Easily connect to these systems with your mobile devices via AirPrint, or the Mopria Print Service. You can unlock additional mobile print and scan features by adding the optional Wi-Fi module.

### User experience

The large and fully customisable user interface makes the MFP simple and intuitive to use. Simply swipe through the menu and select the feature or function you need and modify the screen to suit your individual preferences.

### Dual Scan Document Feeder (DSDf) and Double Feed Detection

The DSDf can hold up to 300 originals, and processes 240 pages per minute by scanning both sides of the page in a single pass. With the Double Feed Detection, you can ensure that no pages are missing after scanning, eliminating the need for manual checking.

# Specifications

## General

<b>Print &amp; Copy Speed</b>	Colour	Monochrome
	A4: 65/65/75 ppm A3: 30/30/37 ppm	A4: 65/75/85 ppm A3: 30/37/40 ppm
<b>Warm-up Time</b>	~ 15 seconds from low power mode	
<b>Paper Size &amp; Weight</b>	Cassettes: A5R-320 x 460 mm, 60-300 gsm Tandem-LCF <sup>1)</sup> : A4, 60-300 gsm Bypass: 100 x 148 mm-330 x 483 mm, 60-300 gsm Banner paper (up to 313.4 x 1,200 mm, 90-163 gsm)	
<b>Paper Capacity</b>	Cassettes: 4x 540 sheets or Cassettes: 2x 540 sheets plus Tandem-LCF <sup>1)</sup> : 1x 2,320 sheets Bypass: 1x 120 sheets, Max. 8,020 sheets	
<b>Automatic Duplex</b>	A5R-A3, 320 x 450 mm-print only, 320 x 460 mm-print only, 305 x 457 mm and other formats, 60-256 gsm	
<b>Controller Type</b>	Toshiba e-BRIDGE Next	
<b>Control Panel</b>	26 cm (10.1") Multi-Touch Colour Panel	
<b>Memory</b>	Security SSD 128 GB <sup>2)</sup> ; 6 GB RAM	
<b>Interface</b>	10Base-T/100Base-TX/1000Base-T, High Speed USB 2.0, WLAN (IEEE802.11a/b/g/n/ac incl. WI-FI direct)/Bluetooth*	
<b>Dimension &amp; Weight</b>	955 x 698 x 1,227 mm (W x D x H), ~ 209 kg	
<b>Initial Consumables</b>	Drums, Developers, Waste Toner Box	

## Print

<b>Resolution</b>	600 x 600 dpi, 5 bit, 1,200 x 1,200 dpi, 2 bit (equiv. 3,600 x 1,200 dpi) with PostScript driver only
<b>Page Description Language</b>	PCL5e, PCL5c, PCL6 (PCLXL), PDF and PS3, (JPEG)
<b>Supported Systems</b>	Windows 11/10, Windows Server 2022/2019/2016/ Server 2012/R2, Mac OS 10.12-13, Linux/Unix, Citrix, SAP, AS-400
<b>Network Protocols</b>	TCP/IP (IPv4/IPv6), Ether Talk, NetBios over TCP/IP
<b>Colour Modes</b>	Auto-Colour (ACS), Colour, TWIN Colour, Monochrome
<b>Colour Settings</b>	ICC profile colour management, RGB substitution, Brightness, Saturation, Contrast, Colour Balance
<b>Mobile Printing</b>	e-BRIDGE Print & Capture, Mopria® Print Service, AirPrint®
<b>Print Functions</b>	Universal Printer Driver, Driver Templates, Driver plug-ins*, Print from USB, Hold Print, Tandem Printing, E-Mail direct printing

## Scan

<b>Resolution</b>	Max. 600 x 600 dpi
<b>Scan Speed</b>	Dual Scan Document Feeder: up to 240 ppm (300 dpi) in colour and monochrome
<b>Scan Modes</b>	Auto-Colour (ACS), Colour, Greyscale, Monochrome
<b>File Formats</b>	JPEG, Multi/Single Page TIFF/XPS/PDF, Secure PDF, Slim PDF, PDF/A-1b, PDF/A-2b, Searchable PDF* (and other formats like DOCX, XLSX)*
<b>Scan Functions</b>	WS Scan, Scan to USB, Scan to E-Mail, Scan to File (SMB, FTP, FTPS, Local), Meta Scan*, OCR scan, Scan to Box (e-Filing), WIA, TWAIN

## Copy

<b>Resolution (Output)</b>	600 x 600 dpi, 5 bit; equiv. 2,400 x 600 dpi with smoothing (monochrome only)
<b>First Copy Output Time</b>	Colour: ~ 6.4/6.4/5.4 seconds Monochrome: ~ 5.2/4.5/4.1 seconds
<b>Zoom</b>	Platen: 25-400%, DSDF: 25-200 %
<b>Copy Modes</b>	Text/Photo, Text, Photo, Printed Image, Map, Image Smoothing
<b>Colour Modes</b>	Auto-Colour (ACS), Full Colour, Twin Colour, Mono Colour, Monochrome
<b>Colour Settings</b>	Hue, Saturation, Colour Balance, RGB adjustment, 5 one-touch modes
<b>Copy Functions</b>	Rotate Sort, ID Card Copy, Edge Erase, 2-in-1 / 4-in-1 mode

## Fax\*

<b>Communication</b>	Super G3, G3 - (opt. 2 <sup>nd</sup> line) Internet Fax T.37
<b>Transmission Speed</b>	~ 3 seconds per page
<b>Compression</b>	JBIG, MMR, MR, MH
<b>Fax Memory</b>	1 GB Transmission/Reception
<b>Network-Fax</b>	Driver for Windows 11/10, Windows Server 2022/2019/2016/Server 2012 R2/Server 2012 (64bit)
<b>Incoming Fax Routing</b>	To shared folders (SMB, FTP), E-Mail, e-Filing

## System & Security

<b>Device Management</b>	Top Access for remote administration and configuration
<b>System Features</b>	e-Filing document server for secure storage, Document distribution and Print-on-Demand (1 public box, 200 user boxes), over 1,2 million one-touch templates for storage of personalised settings and workflows, Scan/Fax Preview, Rip-while-Print, e-BRIDGE Open Platform, Embedded Web Browser, Job Skip, PCL Barcode printing, e-BRIDGE Plus embedded apps
<b>Accounting &amp; Security</b>	Role Based Access, LDAP support, 1,000 department & 10,000 user codes, Card Reader*, Private Print, Standard data encryption with Toshiba Security SSD, Data Overwrite function when optional HDD is chosen, IP and MAC address filter, Port Filter, Support of SSL and IPsec* protocols, IEEE802.1x support, CC certified (ISO/IEC15408) with HCD-PP v1.0*, Scan to Secure PDF, Pull-printing*

# Options

<b>EXTERNAL LARGE CAPACITY FEEDER</b>	2,500-sheet capacity, A4, 60-300 gsm
<b>EXTERNAL LARGE CAPACITY FEEDER</b>	2,000-sheet capacity, A4, 60-300 gsm (in combination with 2500-sheet feeder)
<b>MULTI-STAPLE FINISHER</b>	2 trays, 3,250-sheet capacity, 65-sheet multi-position stapling, A5R-A3, 60-105 gsm (stapling mode)
<b>SADDLE STITCH FINISHER</b>	2 trays, 3,250-sheet capacity, Saddle-stitched booklets of up to 60 pages, 65-sheet multi-position stapling, A5R-A3, 60-105 gsm (stapling mode)
<b>HOLE PUNCH UNIT</b>	Available in 2 holes (E), 4 holes (F)

<b>HARD DISK DRIVE 320 GB<sup>(2)</sup> (FIPS 140-2 STANDARD)</b>
<b>SECURITY SOLID STATE DRIVE 512 GB<sup>(2)</sup></b>
<b>FAX BOARD</b>
<b>USB HUB</b>
<b>ACCESSORY TRAY</b>
<b>PANEL TEN-KEY</b>
<b>WIRELESS LAN/BLUETOOTH MODULE (incl. Wi-Fi Direct)</b>
<b>e-BRIDGE ID-GATE</b>
<b>ACCESSIBLE ARM</b>

<b>IPsec ENABLER (LICENCE)</b>
<b>MULTI STATION PRINT ENABLER (LICENCE)</b>
<b>META SCAN ENABLER (LICENCE)</b>
<b>UNICODE FONT ENABLER (LICENCE)</b>
<b>HARD COPY SECURITY KIT (LICENCE)</b>



<sup>1)</sup> e-STUDIO6526AC LCF version only

<sup>2)</sup> 1 GB = 1 billion bytes; the actual formatted capacity is less. Available capacity will also be less if software applications are pre-installed.

\* Optional

### **About EKS Digital Solutions Ltd**

EKS is a leading supplier of colour and black & white digital photocopiers. Established in 1973 as a family run Stationers and Printers, today EKS offer an extensive range of products from staples and photocopiers, to office and education furniture.

As a Toshiba Authorised Business Partner, all EKS service technicians are Toshiba-trained and able to offer the highest standards of service and expertise.

For more information please contact us:

#### **EKS Digital Solutions Ltd**

100-104 Station Road, Herne Bay, Kent, CT6 5QA

#### **Telephone**

01227 363623

#### **Email**

managedprint@eksLtd.com

#### **Website**

[www.eks-digital.com](http://www.eks-digital.com)

### **About Toshiba Tec UK**

Toshiba Tec UK Imaging Systems Ltd is part of the globally operating Toshiba Tec Corporation, active in various high-tech industrial sectors.

Toshiba Tec Corporation is a leading provider of information technology, operating across multiple industries. With headquarters in Japan and over 70 subsidiaries worldwide, Toshiba Tec Corporation helps organisations transform the way they create, record, share, manage and display information.

For more information please contact us:

#### **Toshiba Tec UK Imaging Systems Ltd.**

Abbey Cloisters, Abbey Green, Chertsey, Surrey KT16 8RB

#### **Telephone**

+44 (0)843 2244944

#### **Email**

[info@toshibatec.co.uk](mailto:info@toshibatec.co.uk)

#### **Website**

[www.toshibatec.co.uk](http://www.toshibatec.co.uk)

